

Approved Autumn 2024  
Review Autumn 2026

**THE GLEBE PRIMARY**  
**SCHOOL**

**Adverse Weather  
and Gritting Policy**





The Glebe Primary School  
Gateway to Learning where Every Body Excels  
Adverse Weather and Gritting Policy

It is the policy of the school to make every effort to remain open whenever possible.

The decision to close the school either before or during the school day will be made by the Head Teacher. The school will only be closed if one or more of the following conditions apply:

1. Insufficient staff are able to come in to keep the school running safely.
2. Conditions on site are dangerous.
3. Conditions are considered to be or are anticipated to later become too hazardous for travel.

If the school is to close:

1. The closure will be recorded on the Stockton Borough Council Website by the Head Teacher.
2. The media, BBC Tees radio, will then broadcast details.
3. Parents will be informed by text and e mail by SchoolComms/Schoolgateway system as soon as possible.
4. Updates and news will be shared on the school social media pages (Facebook & Twitter).
5. The school website homepage will show updates to school closure.

The school will make all practicable efforts to keep parents informed as to the situation with the school during adverse weather conditions, as we appreciate that such conditions and the uncertainty places very considerable difficulties upon parents. However, parents are expected to check the council website, website and/or make themselves aware of the radio broadcasts when it is clear that a closure is a possibility.

The school appreciates that during bad weather children may arrive later than normal; parents should endeavour to contact the school to let them know they are on their way if likely to be delayed. The school recognises there will be isolated instances where families are cut off, even where the clear majority of children can get into school. In such instances parents should inform the school of the circumstances of this exceptional situation, as the school has a duty to clarify the circumstances of each case so as to be able to formally authorise the absence to the Local Authority. Parents acting on the assumption that the school would be closed without gaining confirmation, or failing to inform the school of the circumstances that prevents the child coming into school risks their child being registered as an un-authorised absence. Where the school is officially closed, all absence is counted as authorised absence.

In the event of the school having to close during the day due to unforeseen worsening weather or similar unforeseen circumstances, parents will be contacted by text, e mail and then phone either at home or work and asked to collect their child/ren. Such an early release will only be contemplated in very extreme circumstances.

In the event of snow, pathways on the gritting plan will be cleared. Parents, children and visitors will be made aware that pathways, even where cleared, do remain dangerous. Children will also be reminded of this in assembly.

Before and after school opening hours, parents are responsible for ensuring their children do not slide on the school playground.

In icy conditions the site manager will salt wide pathways to a minimum width of one metre as follows:

- A) From the front gate to the front door
- B) From the side gate to the large playground
- C) From the side gate to the small playground.
- D) the side of the building joining one playground to the other

Where necessary, essential pathways will be maintained as clear as possible throughout the day.

On school days where the school is closed to pupils, the pathway will still be maintained during snow and ice weather on a daily basis by the site manager, so as to keep the pathways clear and prevent build-up of ice and snow.

During significant adverse weather conditions, the gates will be opened from 8.45 am for children to come inside.

During adverse weather conditions, the playground may be out of bounds to parents and children at the beginning and end of school, and if the Head Teacher decides it necessary, at break times as well.

In the Head Teacher's absence the senior teacher on site will assume responsibility for making all decisions relating to the Adverse Weather and Gritting Policy.

### **Gritting**

The school site manager will clear and grit access routes and priority areas identified in the site plan attached as soon as possible on the morning of inclement weather. This will occur, if reasonably practicable, before the arrival of other staff and pupils. Whilst every effort will be made to clear snow and ice it must be remembered that individuals have a responsibility for their own safety and that of others. This means being aware of the potential hazards of walking or driving in icy conditions and acting reasonably in the circumstances.

In the event of heavy rain, ice or snow, children will be able to enter the school as normal at 8.45am. There will be no access to any of the playgrounds as they will be unsafe and some children are unaccompanied. The playground on such days will be out of bounds.

Signage will be positioned at each entrance to school to warn all pedestrians of the risk due to inclement weather.

### **The following areas will be gritted:-**

- Pedestrian paths from the gates - from Saltney and Pulford Road- will be gritted to a 2 metre width up to the entrance gates.
- Nursery path will be gritted from Saltney Road to the entrance.
- The paths in the car park will be gritted to the main school entrance.

**(Extreme caution should be exercised in moving from a vehicle to the path ways)**

It is not practical to grit large areas of grounds therefore if it is thought that playground areas are unsafe due to underfoot conditions they will not be used during the day.  
At the end of the day adults collecting children from the Nursery will use their normal entrance.

Reception children are to be collected from the Reception cloakroom doors.  
Key Stage One and Two children will need to be collected from the normal gates and exit via the gritted pathway.

**It may be possible for paths to have become unsafe during the day when there is no caretaking cover available to grit the paths. It is therefore very important that extreme care is taken when coming on to the school premises later in the day.**

**We reserve the right to adjust/amend all routes treated if resources are depleted or not available.**

**The Glebe Primary School Primary School will manage implementation of this policy with the support and guidance of the Local Authority.**

**Paths outside the school grounds are not the school's area of responsibility. However if you feel that they are dangerous you could contact the Highways department on  
Tel: 01642 360876.**

#### **Priority 1**

**Pedestrian path from side gate on Pulford Road to front entrance.**

**Pedestrian path from side gate on Pulford Road to KS2 playground.**

**Pedestrian path from side gate on Saltney Road to KS2 playground**

**Walkway to entrance gate on KS2 playground.**

**Pedestrian path from side gate on Saltney Road to the Reception entrance.**

**Pedestrian path from side gate on Saltney Road to Nursay entrance.**

**Walkway to entrance gate KS1 playground.**

#### **Priority 2**

**Inner walkway from KS1 inner playground to gate to KS2 playground.**

Inner walkway adjacent to Saltney Road from Nursery to KS2 playground.

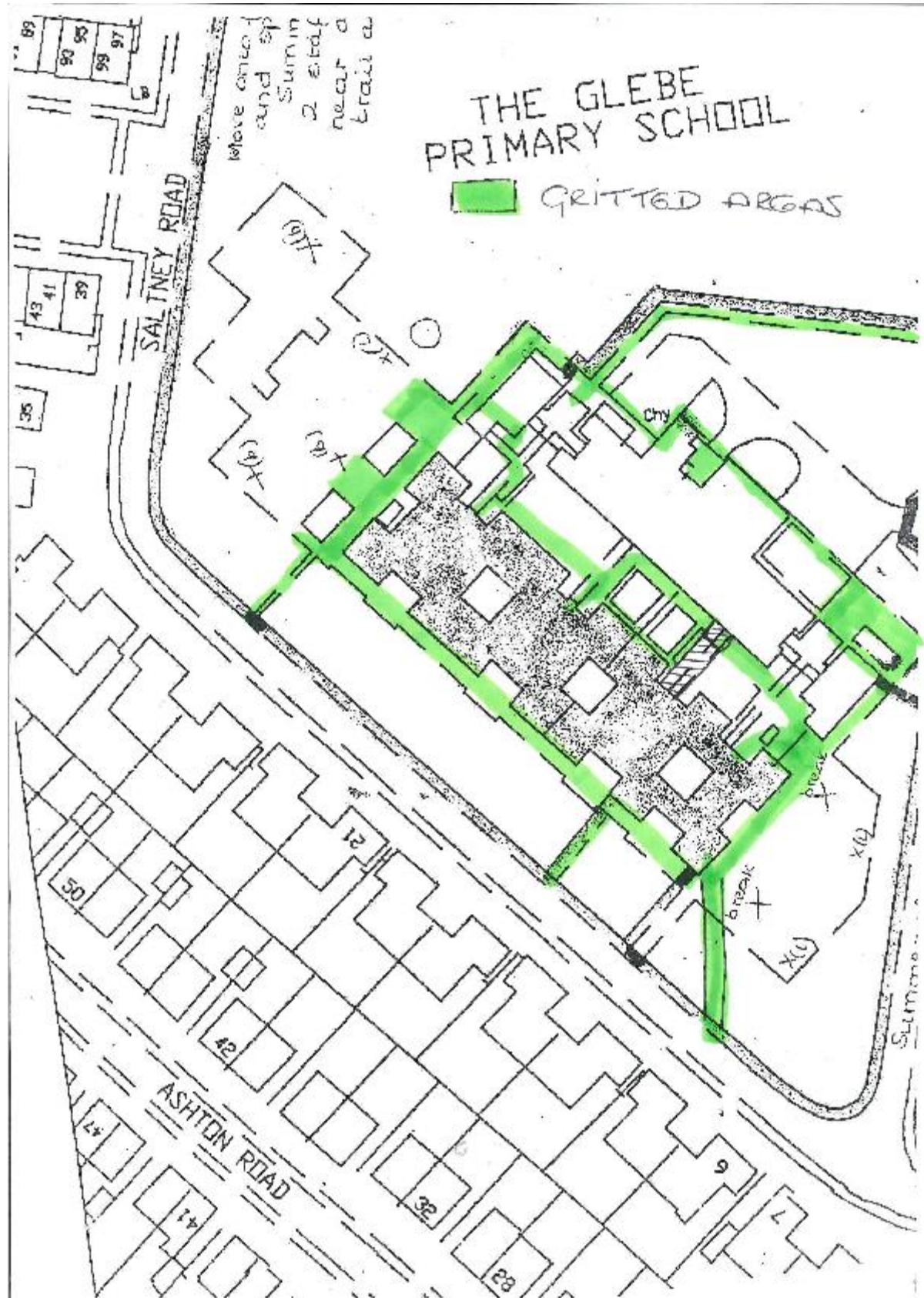

# THE GLEBE PRIMARY SCHOOL

## Bad Weather and Gritting Policy

This statement has been approved at a meeting  
of the Governing Body of the Glebe Primary  
School

On: Autumn 2024.....

To be Reviewed : ...Autumn 2026.....

Chair of Governors: ...Gill Broome.....